



Lake Lansing Advisory Committee

Scheduled Harvester Notice

Monday, August 19, 2024

Planned Harvesting: Progressive ae has engaged PLM to harvest Lake Lansing the week of August 19, 2024.

PLM as a company is very familiar with Lake Lansing. We have the new second harvester access site on Shaw Street completed, so the congestion at the boat ramp may not be as large an issue for the harvest period. We are working to minimize the issues, and also minimize costs and time.

The lake has been surveyed three times now, and the pesky milfoil is still very sparse. There is a significant but normal amount of Pond Weed, Elodea, and Starry Stonewort. The harvester will mainly deal with these plants, and will work mostly from the shoreline out 100 to 300 feet.

Please see attached map for expected harvesting areas.

We expect the harvesting to last approximately three to four days, depending on the weather.

We will continue to monitor and advise as necessary.

This notice and alert through Next Door and Facebook has been processed for the Lake Lansing Special Assessment District Advisory Committee. This notice as well as future and past notices can be found on the Meridian Township website. <http://www.meridian.mi.us/government/boards-and-commissions/lake-lansing-advisory-committee>

Thank you,

Lake Lansing Watershed Special Assessment District
Advisory Committee

□ = 1 ACRE GRID

LAKE LANSING INGHAM COUNTY, MICHIGAN HARVEST MAP SURVEY DATE: AUGUST 14, 2024

Legend

 Harvesting (macro-algae and native plants) = 38.25 acres

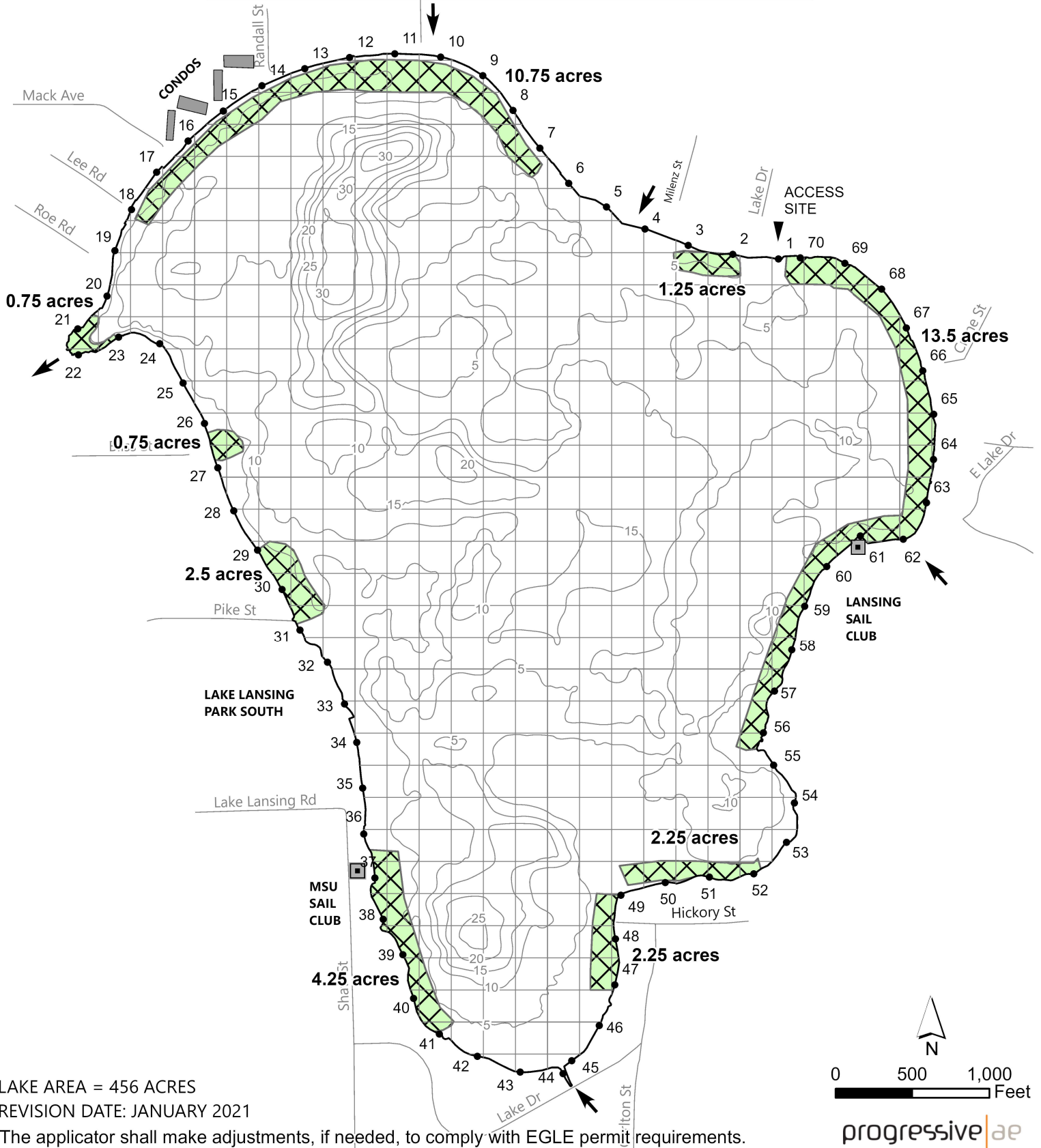

LAKE AREA = 456 ACRES
REVISION DATE: JANUARY 2021

The applicator shall make adjustments, if needed, to comply with EGLE permit requirements.