



FOR IMMEDIATE RELEASE
February 28, 2024

CONTACT: Dan Opsommer, Deputy Township Manager
517.853.4440 | dpw@meridian.mi.us

ADDENDUM #1
2024 Public Safety Building Standby Generator RFP

Addendum #1 includes one revision to “Appendix C – Site Plan”, which simply moves the service entrance rated ATS (800A) and the rotary transfer switch to the east exterior wall of the building.

Please note: you must sign this addendum and include it with your proposal.

Date	_____	Company Name	_____
By	_____	Address	_____
	Signature		
	_____		_____
	Printed Name		
Title	_____	Phone Number	_____
		Email Address	_____

The community of Meridian Township is in close proximity to the Michigan State Capitol and Michigan State University. The Township serves the community through exceptional services, beneficial amenities and an outstanding quality of life. It is a welcoming community that celebrates quality education, recreation and lifestyles.



Utility Services:

*Pull electrical permit through Meridian Township.

*Contract with CMS Energy for abandoning old generator gas service, extending new gas service, and reconfiguring the electrical service, as necessary.

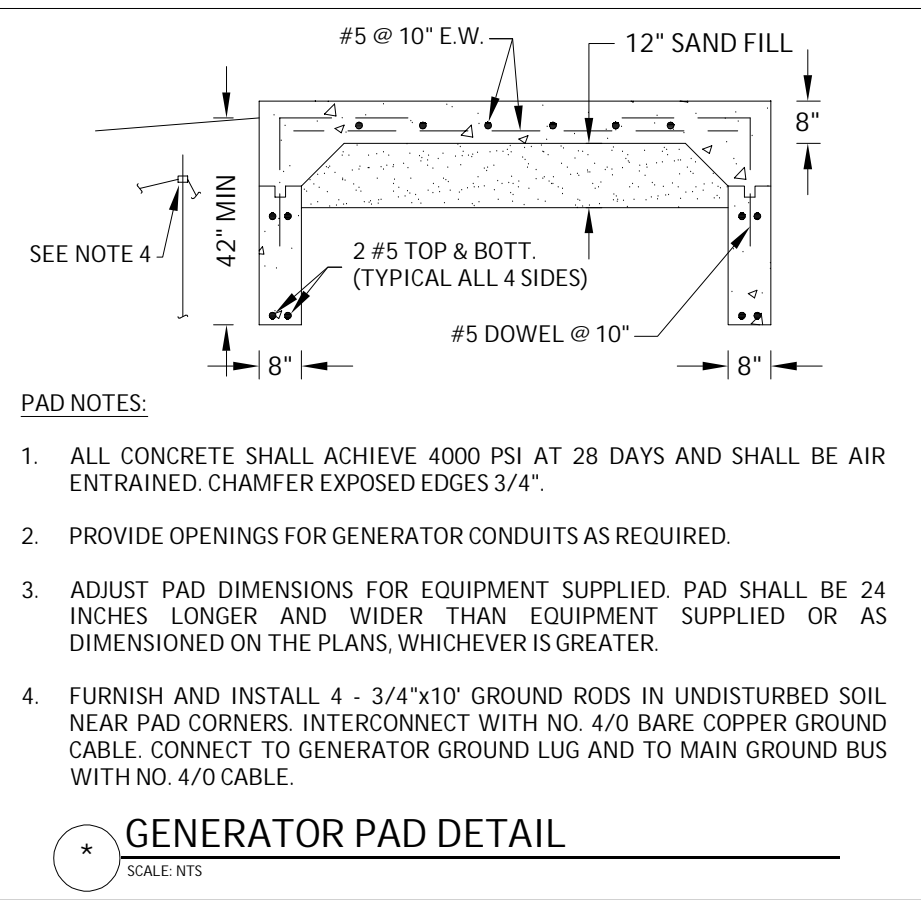
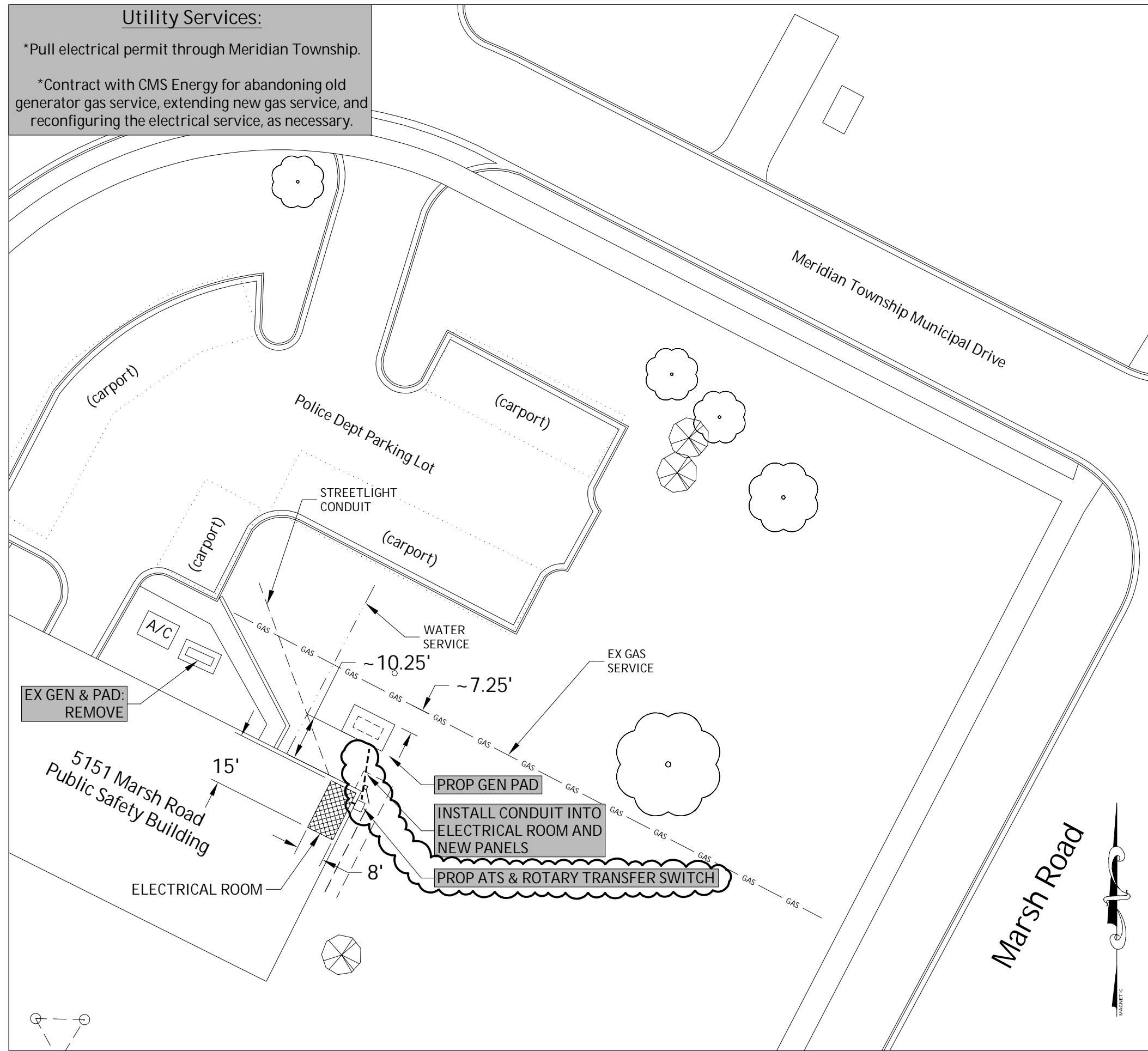

Proposed Station Specs:

Generator - 100kW
 ATS - 800A
 Fuel Operating Pressure - 6.0 to 13.0 In. H₂O

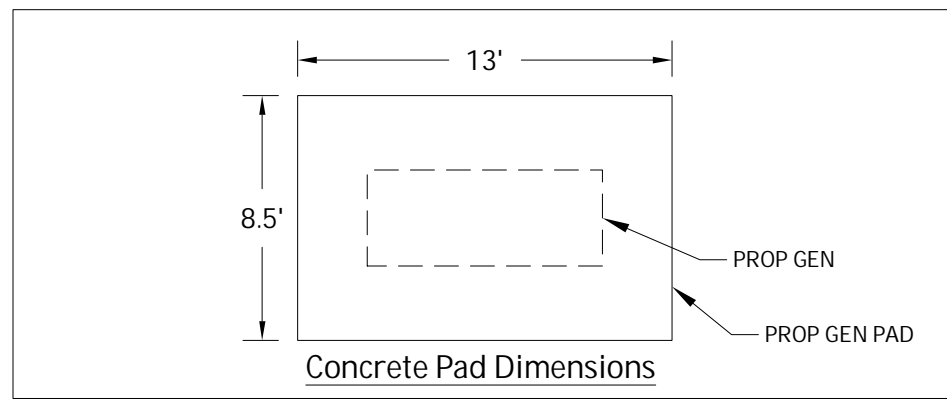

Meridian Charter Township Ingham County, Michigan Facilities		REVISIONS:	
DATE:	BY:	DATE:	BY:
01.25.23	NN		
		COMMENTS:	
		Plan for Bid	
Public Safety Building 5151 Marsh		SCALE:	PAGE:
		1" = 30'	Apx C
DRAWN BY: NN 01.25.23	CHECKED BY:	FILE:	