



Lake Lansing Advisory Committee
Scheduled Harvester Notice
Monday, September 13-16, 2021

Planned Harvesting: Progressive ae has engaged PLM to harvest Lake Lansing the week of September 13, 2021.

PLM as a company is very familiar with Lake Lansing. Ingham County does not have the new second harvester access site on Shaw Street completed, so the congestion at the boat ramp may be an issue for a couple days. We are working to minimize the issues.

The lake has been surveyed three times now, and the pesky milfoil is still very sparse. There is a significant but normal amount of Pond Weed, Elodea, and Starry Stonewort. The harvester will mainly deal with these plants, and will work mostly from the shoreline out about 300 feet.

Please see attached map for expected harvesting areas.

We expect the harvesting to last approximately three days, depending on the weather.

We will continue to monitor and advise as necessary.

This notice and alert through Next Door and Facebook has been processed for the Lake Lansing Special Assessment District Advisory Committee. This notice as well as future and past notices can be found on the Meridian Township website. <http://www.meridian.mi.us/government/boards-and-commissions/lake-lansing-advisory-committee>

Thank you,

Lake Lansing Special Assessment District
Advisory Committee

☐ = 1 ACRE GRID

LAKE LANSING INGHAM COUNTY, MICHIGAN AUGUST 23, 2021 HARVESTING MAP

 Harvesting of nuisance native plants and starry stonewort = 36 acres

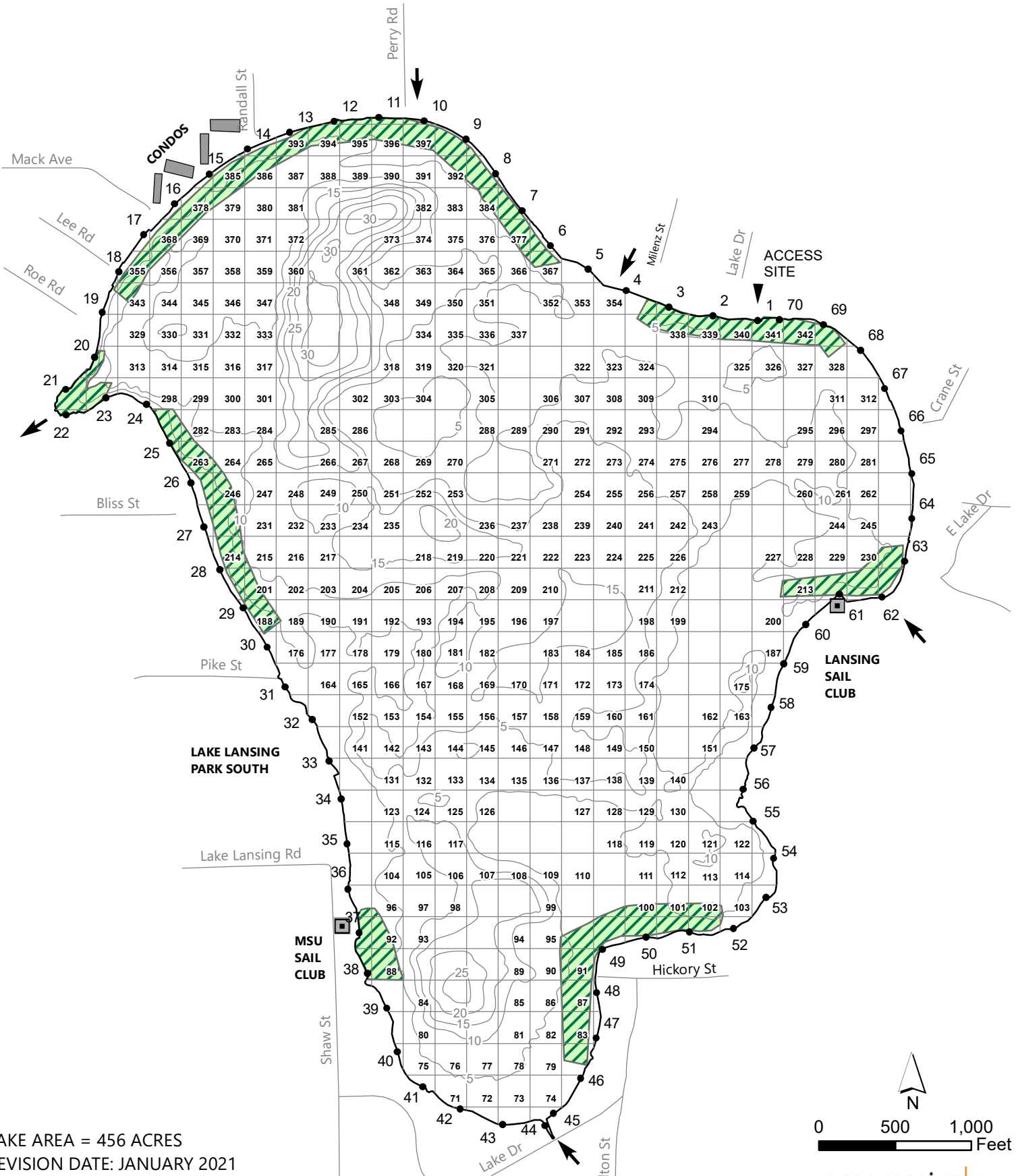

LAKE AREA = 456 ACRES
REVISION DATE: JANUARY 2021

The applicator shall make adjustments, if needed, to comply with EGLE permit requirements.